

TO ANANDMAYEE MARG

GOVINDPURI EXTENSION

GOVINDPURI MAIN ROAD

ROAD

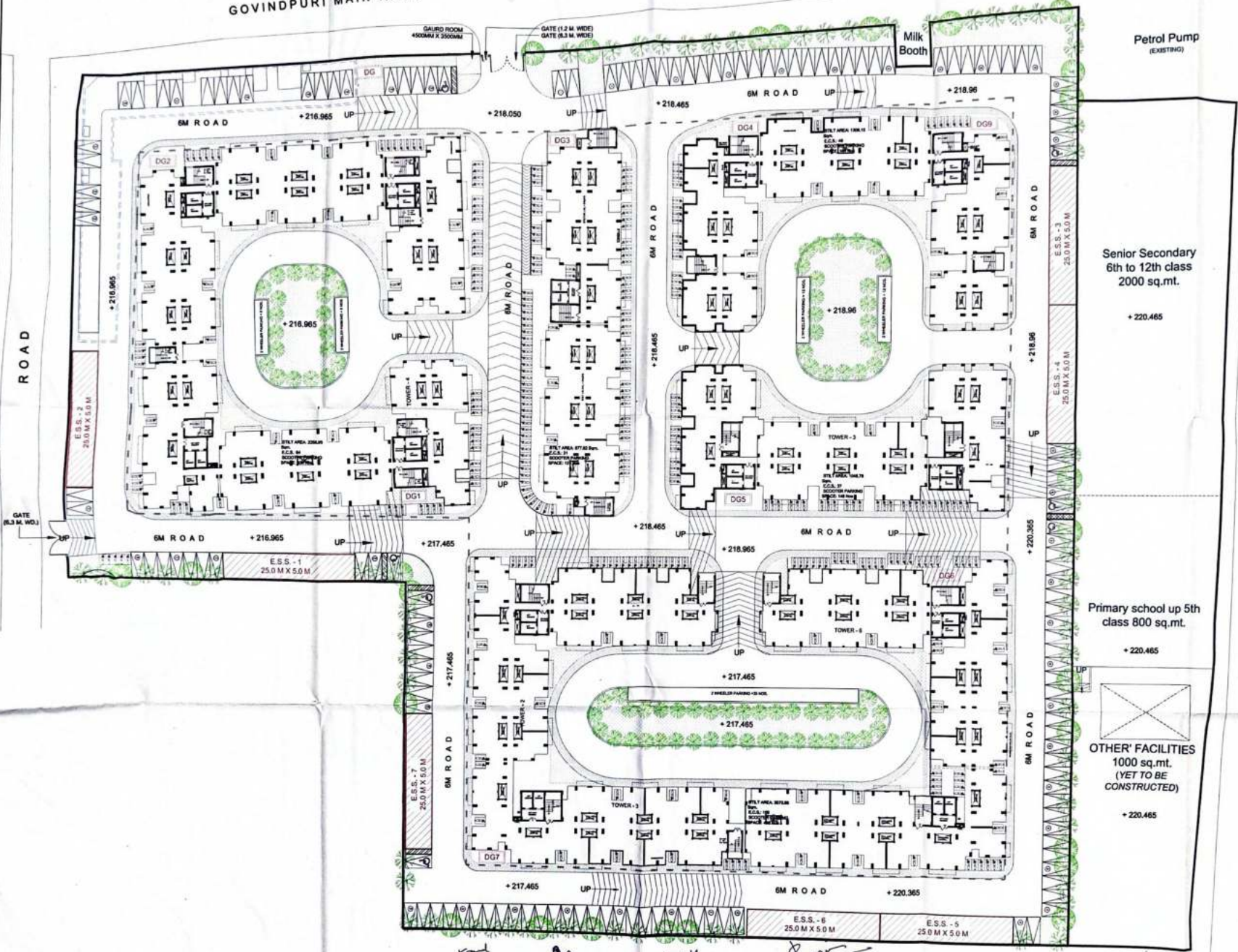

541C
DELHI DEVELOPMENT
AUTHORITY

AREA STATEMENT

TOTAL PLOT AREA	= 200610.00 SQ.MT
AREA UNDER PRIMARY SCHOOL	= 220.465 SQ.MT
AREA UNDER SECONDARY SCHOOL	= 220.465 SQ.MT
AREA UNDER OTHER FACILITIES	= 1000.000 SQ.MT
TOTAL AREA UNDER BUILDINGS	= 1440.930 SQ.MT
AREA UNDER OTHER FACILITIES	= 1000.000 SQ.MT
TOTAL AREA UNDER PAVEMENT	= 2440.930 SQ.MT
AREA UNDER GREEN SPACES	= 2620.070 SQ.MT
TOTAL AREA UNDER UTILITIES	= 1440.930 SQ.MT
AREA UNDER OPEN SPACES	= 2620.070 SQ.MT
TOTAL AREA UNDER UTILITIES AND OPEN SPACES	= 4240.100 SQ.MT
TOTAL AREA UNDER UTILITIES AND OPEN SPACES INCLUDING FACILITY PLOTS	= 3820.100 SQ.MT

PERMISSIBLE COVERAGE OF 20%
 PERMISSIBLE COVERAGE UNDER PAVEMENT
 PERMISSIBLE COVERAGE UNDER GREEN SPACES
 PERMISSIBLE COVERAGE UNDER UTILITIES AND OPEN SPACES

PERMISSIBLE COVERAGE UNDER PAVEMENT
 PERMISSIBLE COVERAGE UNDER GREEN SPACES
 PERMISSIBLE COVERAGE UNDER UTILITIES AND OPEN SPACES

PERMISSIBLE COVERAGE UNDER PAVEMENT
 PERMISSIBLE COVERAGE UNDER GREEN SPACES
 PERMISSIBLE COVERAGE UNDER UTILITIES AND OPEN SPACES

PERMISSIBLE COVERAGE UNDER PAVEMENT
 PERMISSIBLE COVERAGE UNDER GREEN SPACES
 PERMISSIBLE COVERAGE UNDER UTILITIES AND OPEN SPACES

PERMISSIBLE COVERAGE UNDER PAVEMENT
 PERMISSIBLE COVERAGE UNDER GREEN SPACES
 PERMISSIBLE COVERAGE UNDER UTILITIES AND OPEN SPACES

Petrol Pump
(EXISTING)

Senior Secondary
6th to 12th class
2000 sq.mt.

+220.465

DELHI DEVELOPMENT AUTHORITY
CERTIFIED

Approved on 25/11/2021

Case No: 83/2021

Vide Item No. 83/2021

Sig: [Signature]

Design: [Signature]

DELHI DEVELOPMENT AUTHORITY
HUPV-CO-ORDINATION
VERIFIED

This proposal was considered in the Standing Committee Meeting held on 25/11/2021

Vide Item No. 83/2021

Dy. Director (Arch.) Co-ordinate

AS BUILT DRAWINGS

NOTE:

The proposal has been approved in 400th SCM held on 25/11/2021

Vide Item no. 83/2021

Primary school up 5th
class 800 sq.mt.

+220.465

OTHER FACILITIES
1000 sq.mt.
(YET TO BE
CONSTRUCTED)

+220.465

JL/SPP-1 JL/SPP-2 JL/SPP-3 JL/SPP-4 JL/SPP-5 JL/SPP-6

DRAWING TITLE:
LAYOUT PLAN
(AS BUILT DRAWING)

PROJECT:
N.O.W. IN SITU REHABILITATION AT
A-14 KALKAJI EXTN.
SH: C/o 3000 Multistoreyed DUs at
Community Centre site

EPC CONTRACTOR:
ERA INFRA ENGINEERING LTD.
152, CHOLA INDUSTRIAL ESTATE
PHASE - III, NEW DELHI- 110020

STRUCTURAL CONSULTANT:
DR. P.C. RAGTAH & ASSOCIATES
19/5 OLD RAJENDRA NAGAR, NEW DELHI -
110060.
PH: 25713496, 25786386. FAX: 25766386.
E-MAIL: PCRAGTAH@GMAIL.COM

CONSULTANT:
ADLAKHA ASSOCIATES PVT. LTD.
F - 70, FIRST FLOOR, BHAGAT SINGH
MARKET, GOLE MARKET,
NEW DELHI - 110001.
PH: 011-23344471, 23344472.

NORTH

N

COPYRIGHT:
THIS DRAWING IS THE PROPERTY OF ADLAKHA ASSOCIATES
PVT. LTD. IT SHALL NOT BE REPRODUCED, COPIED, USED IN
ANY MANNER OR TRANSMITTED IN ANY FORM OR BY ANY
PARTY WITHOUT THE PRIOR PERMISSION OF ADLAKHA
ASSOCIATES PVT. LTD.